

# Battery Powered Soldering Iron with Pivoting Head

## Model: ZD-20L

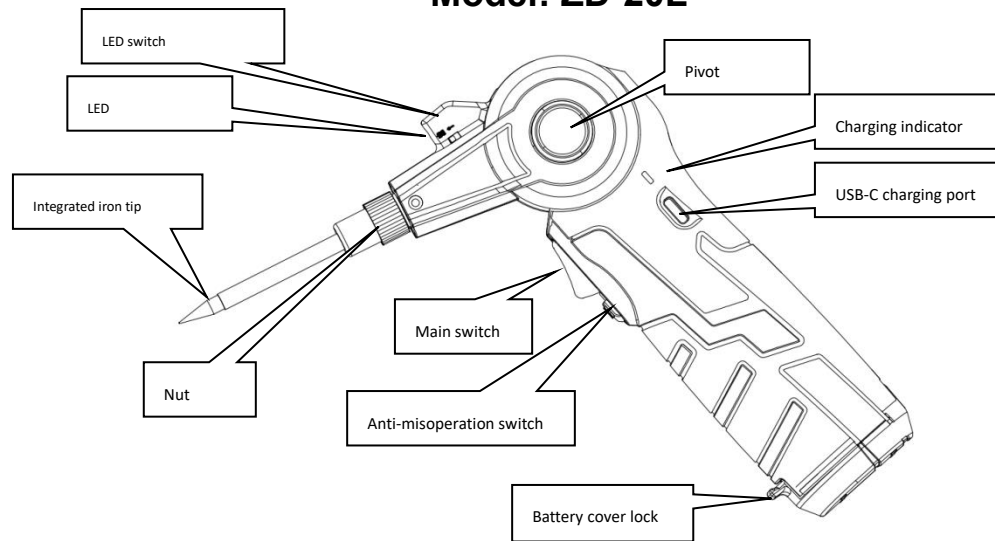

### Features

- Heats up quickly.
- It has LED for illumination with an LED switch.
- Soldering iron tip's structure is easy to disassemble and replace.
- USB type-C interface.
- The internal chip of the battery operates with constant current/constant voltage and heat regulation to maximize battery management efficiency, without the risk of overheating.
- It manages the lithium battery through the USB interface, monitoring the charging current input and output. To protect the lifespan of the battery, the charging current is automatically reduced when the battery level reaches 90%. Then trickle charging is employed until the battery is fully charged.
- Do not charge and use the item simultaneously
- The product is equipped with an anti-misoperation switch that prevents accidental heating during transportation or travel.
- When the switch is turned off, the battery does not consume power.
- Comes with a rubber-coated housing with an attractive appearance and sturdy structure.

### Specifications

- Temperature: Max 450°C
- The pivoting head can be adjusted into different angles from 0° -75° .

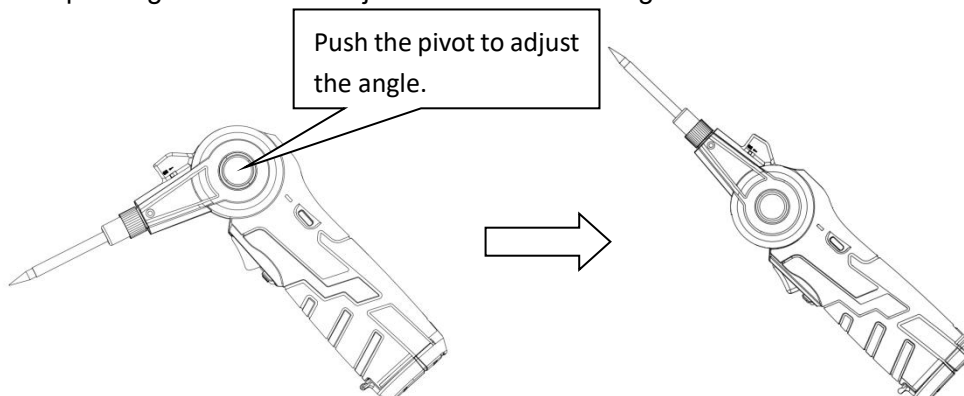

- Powered by 1PC of 18650 rechargeable battery.
- A detachable USB cord included.

- Comes with 2 in 1 non-detachable heater with tip(79-0021).

## Spare tips

### Spare tips

Code	Note
79-0021	
79-0022	High quality
79-0023	

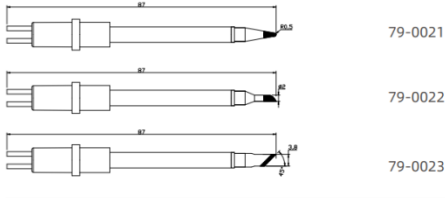

## Battery Instructions

The item charges through a DC 5V Type-C interface. Taking a 2200mA battery as an example, it can be used for more than 2 hours when fully charged. When the light becomes dimmer, it indicates the battery needs to be charged. The red light is on during charging and it will turn to green after the battery is fully charged.

**Note:** Use the original battery. If purchased separately, it should be a 3C or above-rated 18650 rechargeable battery.

## How to change the battery

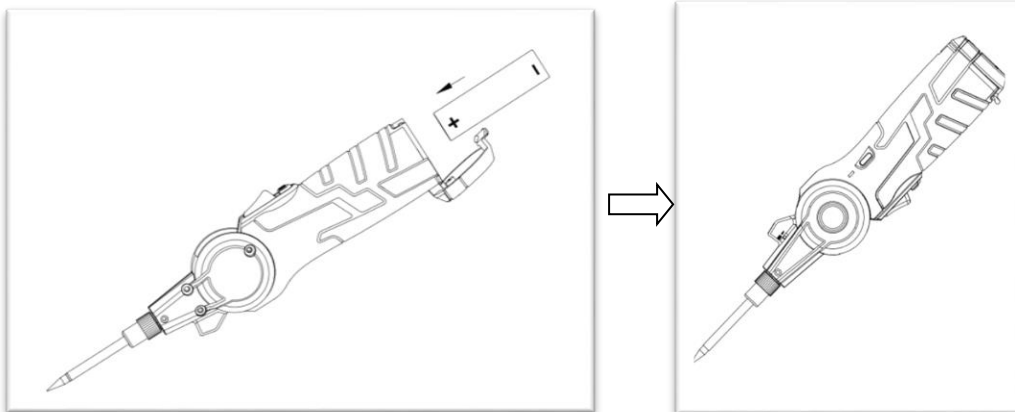

For the first use, open the battery compartment and insert the battery (Note: Ensure correct polarity when inserting the battery, positive end inward, then close the cover).

## Operation

- Open the packaging and check all parts. Do not use if any parts are damaged.
- Place the item on the soldering iron stand.
- Place the item on a stable and dry surface.
- Wait for the tip to reach the desired temperature. Test the temperature by touching the solder with the tip. If the solder easily melts, you can begin soldering.
- Before use, tin the heated soldering iron tip with solder.
- Heat the soldering joint with the tip and apply solder.
- Allow the soldering iron to cool naturally on the stand.
- Do not file the soldering iron tip or it will get damaged.
- Always place the soldering iron on the stand when heating or during breaks in soldering.
- Ensure a clean working environment when soldering.

## Charging

If the item is unable to melt the solder or the temperature is insufficient, it needs to be charged promptly. When charging, connect the USB-C cable to the power supply. The red light will be on during charging, and the green light will be on when fully charged.

## Attention!

- The product can only be used indoors, never outdoors. Do not expose to moisture, under any circumstances.
- When the item is in operation, do not touch the outer tube or soldering iron tip to avoid burns. Place it on a stand or upright on a desktop.
- Always keep tips coated with tin to ensure a long service life.
- Handle the heated soldering iron with extreme care, as the high temperature of the iron can cause fires or painful burns.
- This tool must be placed on its stand when not in use.
- Avoid contact with any hot surfaces. The soldering iron tip temperature can be very high during use.
- Exercise extra caution when using the soldering iron near flammable materials.
- Harmful fumes may be generated during the soldering process. Work in a well-ventilated space or an environment with an exhaust system.
- Wear appropriate protective equipment to protect your eyes and body from splattering hot solder.
- When not in use or before cleaning, turn off the product and turn on the anti-misoperation switch to prevent accidental activation.
- Allow the item to cool before cleaning or storage.
- Do not immerse the item in any liquid. Do not use the item to heat plastic or liquids.
- Do not disassemble or attempt to repair the item. It does not contain user-serviceable parts.
- **This appliance can be used by children aged from 8 years and above and persons with reduced physical, sensory or mental capabilities or lack of experience and knowledge if they have been given supervision or instruction concerning use of the appliance in a safe way and understand the hazards involved. Children shall not play with the appliance. Cleaning and user maintenance shall not be made by children without supervision. Children should be supervised to ensure that they do not play with the appliance. If the supply cord is damaged, it must be replaced by the manufacture, its service agent or similar qualified persons in order to avoid a hazard.**

## Battery Safety

1. Battery model: 18650; voltage: 3.6V
2. Dimensions:
3. Default state of the battery

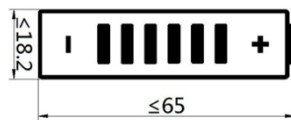

The state of charge is at about 45%. The open circuit voltage is 3.700V~3.750V.

Because the battery will consume electricity by itself, 45% state of charge can't be guaranteed when it reaches customers. Violent vibration, shock, exposure to the sun or rain during transportation must be avoided.

4. Life expectancy: standard cycle and continuous use for 300 times before the state of charge drops to 80% of its standard state of charge.
5. Temperature range during use:  
Charging: 0~50°C (<45°C advised)  
Discharging: -20~ 65°C (<60°C advised)
6. When using a new battery or a battery to be used for the first time after long term storage, please fully charge the battery before using.

7. Prohibition of reverse charge.
8. Never put a battery into water or seawater.
9. Keep the battery away from babies and children. If swallowed, see a doctor immediately.
10. In the event of a cell leaking, do not allow the liquid to come into contact with the skin or eyes. If contact has been made, wash the affected area with copious amounts of water and seek medical advice.
11. When not using a battery, disconnect it from the device.
12. Unplug a battery by holding the connector itself and not by pulling at its cord.
13. Used batteries should be treated by authorized units.
14. After extended periods of storage, it may be necessary to charge and discharge the batteries several times to obtain maximum performance.
15. Secondary batteries give their best performance when they are operated at normal room temperature.
16. Keep batteries clean and dry.
17. Wipe the battery terminals with a clean dry cloth if they become dirty.
18. When disposing of secondary batteries, keep batteries of different electrochemical systems separate from each other.