

1.INPUT:

3377430

- 1.1 Input voltage rating : 100-240V AC
- 1.2 Input voltage range: 90-264V AC
- 1.3 Input frequency rating : 60/50Hz
- 1.4 Input frequency range: 63/47Hz
- 1.5 AC input current: 0.4A Max .@100V AC
- 1.6 AC input power saving: 0.3W Max .@230V AC at no load
- 1.7 Inrush Current: 30A Max .@100VAC cold start
60A Max .@230VAC cold start
- 1.8 Leakage current: 0.25mA Max

2. Output characteristics

- 2.1 Output voltage: 24V
- 2.2 Max. load current 0.65A
- 2.3 Min. load current 0A
- 2.4 Output no-load voltage: 24V±5%
- 2.5 Output load voltage: 24V±5%
- 2.6 Output ripple & noise: 300mV max.

Measured by using a 12inch twisted pair terminated with a 10uF capacitor and 0.1uF ceramic in parallel

3. General characteristics

- 3.1 Total output power: 15.6Watts
- 3.2 Efficiency measurement : 77%(Min.)@full load & input 230VAC, Output set to 24V/0.65A.
For production testing: 77%(Min.)@full load & input 115VAC, Output set to 24V/0.65A.
Efficiency : 77.85%(Min.) at 115Vac 60Hz and 230Vac 50Hz input,
and 25%, 50%, 75%, 100% of full load after 20minutes warm-up.
i.e. meet CEC level V and Erp 2 .
- 3.3 Short circuit protection: No damage when output is shorted to GND.
And after short circuit , auto restart .
- 3.4 Overshoot / Undershoot: 24V±10%

4. Environment:

- 4.1 Operating temperature: 0~40°C
4.2 Storage temperature: -25°C to 70°C
4.3 Operating humidity: 8% to 90%
4.4 Storage humidity: 5% to 95%

5. Application safety standard : meet

- | | | | |
|-----------------------------------|-----------------------------------|--|---------------------------------|
| <input type="checkbox"/> UL 60950 | <input type="checkbox"/> EN 60950 | <input checked="" type="checkbox"/> AS/NZS 60950 | <input type="checkbox"/> J60950 |
| <input type="checkbox"/> UL 60065 | <input type="checkbox"/> EN 60065 | <input type="checkbox"/> AS/NZS 60065 | <input type="checkbox"/> J60065 |
| <input type="checkbox"/> UL 1310 | <input type="checkbox"/> EN 60335 | <input type="checkbox"/> GB4943 | <input type="checkbox"/> J61558 |
| | <input type="checkbox"/> EN 61558 | <input type="checkbox"/> GB8898 | |

6. EMI standard : meet

- | | |
|--|--|
| <input type="checkbox"/> FCC Part 15 Class B | <input type="checkbox"/> GB 9254-2008 |
| <input checked="" type="checkbox"/> EN 55022: 2010+AC:2011 | <input type="checkbox"/> GB 17625.1-2012 |
| <input type="checkbox"/> EN 55013: 2013 | <input type="checkbox"/> J55022 |
| | <input type="checkbox"/> J55013 |

7. HI-POT test

- (1)Primary to secondary: 4525VDC for 3sec. 5mA(production testing)
4242VDC for 1min. 5mA(Sample testing)
(2)Primary to case: 4525VDC for 3sec 5mA(Production test)
(only for metal case)

8. Insulation resistance

Input to output: >10Mohm.@500VDC

9. Reliability:

- 9.1 MTBF: 50K hours min. @full load at 25°C ambient temperature
9.2 Burn-in: 2-4hours,25~45°C ,Input 220VAC,Output 80% load .
9.3 Altitude: Will operate properly at altitude between 0 to 10000ft

10. Mechanical

10.1 Dimensions: Please see the mechanical dimension drawing.

10.2 Weight: 101.8g

11. Mechanical specification:

11.1 AC plug: as drawing

11.2 AC CORD: as drawing

11.3 DC cord:

11.3.1 Bending test: With load 200g, then bend 120 degree at ratio of 45times/minute.

18AWG	4500cycles Min
-------	----------------

20AWG	2400cycles Min
-------	----------------

22AWG	2000cycles Min
-------	----------------

24AWG	1500cycles Min
-------	----------------

11.4 Cord length: attached drawing

11.5 Output plug: attached drawing

11.6 Case Size: attached drawing

11.7 Label

11.8 Package

SAMPLE PRIMARY TEST REPORT/样品初测报告

CUSTOMER/客户		Radio		PRODUCT NO./产品编号						GPE125				
MODEL NO./产品型号														
Test Items./测试项目	Test Condition/测试条件	Unit/单位	Sample quantity and test result/样品数量和测试结果										Pass/Fail	
			1#	2#	3#	4#	5#	6#	7#	8#	9#	10#		
Unload output voltage/ 空载输出电压(0.0A) 22.8Vdc - 25.2Vdc	90Vac	V	24.14	24.02	24.04									PASS
	115Vac	V	24.13	24.01	24.08									PASS
	230Vac	V	24.07	23.96	24.05									PASS
	264Vac	V	24.06	23.94	24.04									PASS
Rated load output voltage/ 额定负载输出电压 (0.65A) 22.8Vdc - 25.2Vdc	90Vac	V	24.49	24.43	24.52									PASS
	115Vac	V	24.50	24.44	24.53									PASS
	230Vac	V	24.50	24.45	24.53									PASS
	264Vac	V	24.51	24.44	24.53									PASS
Output ripple & noise voltage/ 输出纹波及噪声电压 ≤ 300mV	90Vac	mV	122	156	142									PASS
	115Vac	mV	125	138	134									PASS
	230Vac	mV	145	125	129									PASS
	264Vac	mV	138	122	128									PASS
Short-circuit protection test/ 短路保护测试	90Vac	W	0.001	0.004	0.003									PASS
	264Vac	W	1.59	1.43	1.62									PASS
Over current protection/ 过流保护点 (≥0.78A)	90Vac	A	0.80	0.79	0.81									PASS
	264Vac	A	0.88	0.89	0.88									PASS
IC Vcc voltage test/ Vcc电压测试 (规格 ≤ 27V)	90Vac	V	16.87	16.76	16.82									PASS
	264Vac	V	16.96	16.82	16.89									PASS
Hi-pot test/ 介电强度	4242Vdc/5mA/ 1Minute		OK	OK	OK									PASS
Appearance/ 外观	无刮伤,字迹清晰 无误		OK	OK	OK									PASS
Mosfet(IC)/Vds耐压测试	264Vac	V	570	Mosfet规格		600		Derating ≤ 95% Max. Volt.		95.00%			PASS	
输出肖特基D/Vrr耐压测试	264Vac	V	167	Diode规格		200		Derating ≤ 90% Max. Volt.		83.50%			PASS	
变压器反馈绕组上所连接电阻(R)功率损耗(PD)	90Vac	P	-	R(功率)规格		-		Derating ≤ 65% Max Power		-			PASS	
	264Vac	P	-	R(功率)规格		-		Derating ≤ 65% Max Power		-			PASS	

DATE / 日期	2012.07.10	EDITION / 版本	0	PAGE / 页码	0F
TEST / 测试	陈彬	EE CHE./审核		EE CHE./审核	

Model :

Date : 2012.07.10

Tested by : 陈彬

Environment : ● Ambient ○ High ○ Low : 25°C

Test Condition: Vac=115V/230V ,Load :0~100% step Load :25%

1 Vin: 115Vac/60Hz							
Load (%)	Vout(V)	Iout(A)	PF	Pin(w)	Po(w)	Efficiency	Result
0	24.15	0.000	---	0.17	0	0.0%	PASS
25	24.58	0.163	---	4.87	3.99425	82.0%	---
50	24.74	0.325	---	9.66	8.0405	83.2%	---
75	24.63	0.488	---	14.39	12.007125	83.4%	---
100	24.52	0.650	---	19.22	15.938	82.9%	---
Po_typical (w)				15.6	Average 82.9% PASS		
					Spec. 79.51%		V

1 Vin: 230Vac/50Hz							
Load (%)	Vout(V)	Iout(A)	PF	Pin(w)	Po(w)	Efficiency	Result
0	24.08	0.000	---	0.21	0	0.0%	PASS
25	24.48	0.163	---	4.94	3.978	80.5%	---
50	24.65	0.325	---	9.65	8.01125	83.0%	---
75	24.63	0.488	---	14.24	12.007125	84.3%	---
100	24.52	0.650	---	19.05	15.938	83.7%	---
Po_typical (w)				15.6	Average 82.9% PASS		
					Spec. 79.51%		V

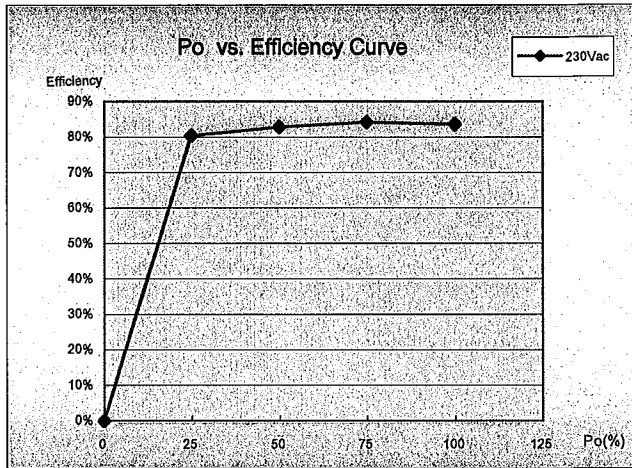
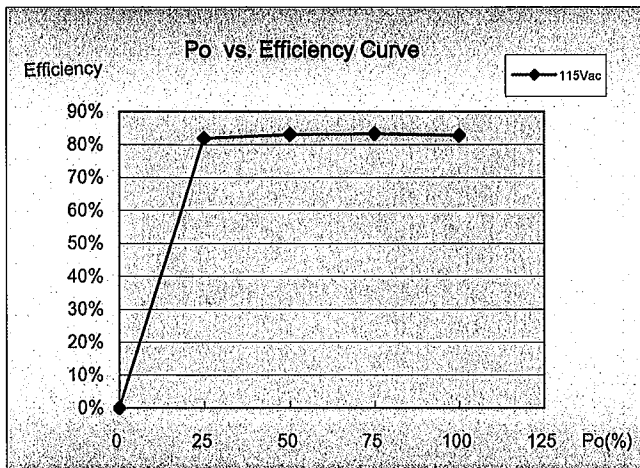

Model :

Date : 2012.07.10

Tested by : 陈彬

Environment : Ambient High Low : 25°C

No.	90Vac		264Vac	
	Min. load	Max. load	Min. load	Max. load
1#	89	322	93	238
2#	57	356	61	222
3#	68	242	72	228
4#				
5#				
6#				
7#				
8#				
9#				
10#				
11#				
12#				
13#				
14#				
15#				
16#				
17#				
18#				
19#				
20#				

Specification : 300

Measured : 356.0

Test result : FAIL

版本	变更内容	变更人	变更时间
B	1. 内长变为25MM 2. 转换头由YX399变更为YSD611	向增娟	2012. 11. 13

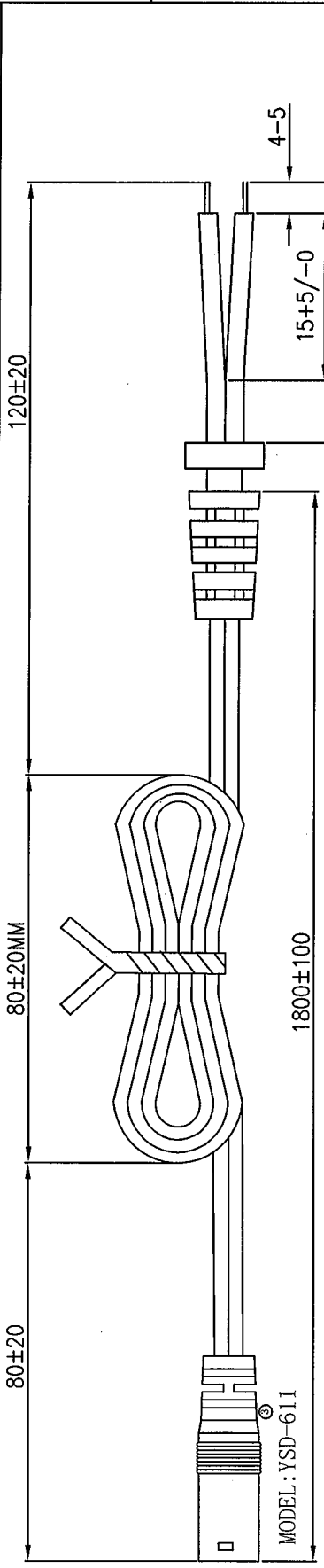

线材规格: 黑色 22# 印白边线接内孔 DC 母头配一可换插头

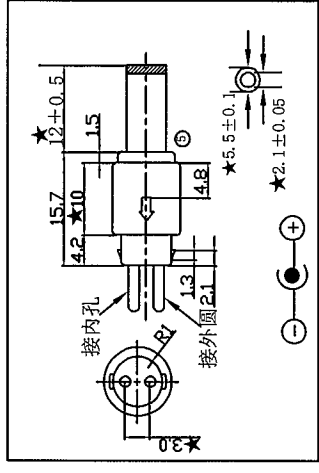

箭头指示正极
★为重点尺寸

★为重点尺寸

技术要求:

1. 线材摇摆测试, 拉力测试依照金盈线材测试标准。
2. 热变形温度大于60度。
3. 产品必须符合ROHS+PAHS+16P要求。

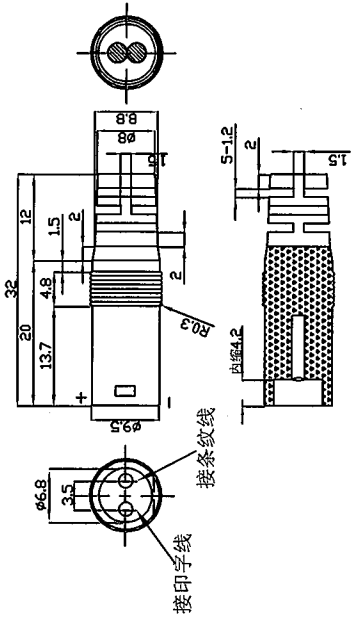

MODEL: YSD-611

DC 头规格:

编号: YSD611

包胶材质: 50+/-5P PVC 黑色

DC 头规格: 平头黑胶 2.1X5.5X12 直头

DC 直头配母头可拆卸转换

SR规格:

编号: YX462(828)

材质: 70+/-5P PVC 黑色

15-0222-0592

版本	变更内容	变更人	变更时间

