

PUC 1070 Ceiling plate tilt

Article number (SKU) 7210704
Colour Black

The PUC 1070 ceiling plate is a part of the modular Connect-it system with which you can create a ceiling solution for medium- to large-sized displays.

This ceiling plate is suitable for flat and inclined ceilings (up to 90°). PUC 1070 has a fixed display position to the ceiling plate and can not be turned. It is ideal for 90 degrees angled mounting in front of window or in a vide. Combine this ceiling plate with one of the poles from the Connect-it Series (PUC 2508/ 2515/ 2530), Connect-it interface bar (PFB 3402/ PFB 3405/ 3407/ 3409/ 3411) and Connect-it interface display strips (PFS 3302/ 3304/ 3306/ 3308/ 3311) for a complete ceiling solution.

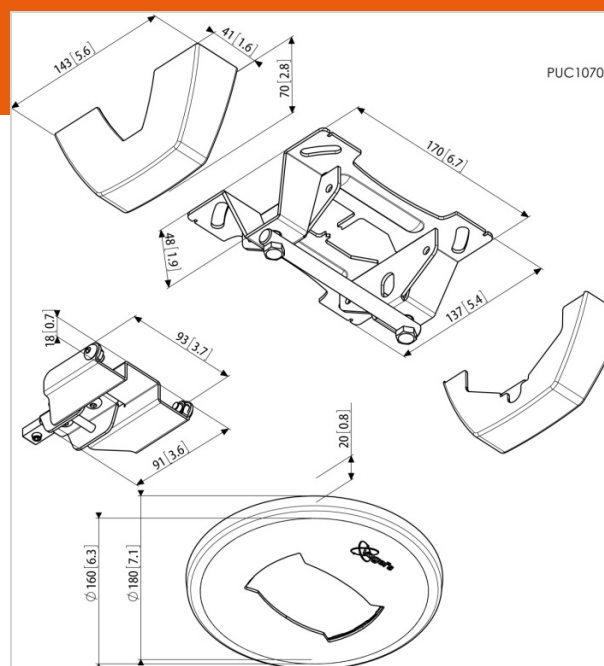

PUC 1070 Ceiling plate tilt

www.vogels.com

VOGEL'S HOLDING BV 2017 (c) All rights reserved
Subject to printing errors, technical and price
amendments
Date: 15-05-2017

Specifications

Product specifications

Product type number	PUC 1070
Article number (SKU)	7210704
Colour	Black
EAN single box	8712285318689
Tilt	Tilt up to 90°
Guarantee	5 years
Max. weight load (kg)	80

Features

Functionality Tilt

