

# 23X 1080P Network IR PTZ Camera

## Quick Start Guide

Thank you for purchasing 23X 1080P HD Network IR PTZ Camera . Before installation, please verify the model of the camera and read this guide carefully.

### Warnings

Installation and servicing should be performed only by qualified and experienced personnel to conform to all related codes and to maintain your warranty.



24V DC models require the use of CCC Certified power adapters to ensure compliance with electrical safety standards.



**CAUTION**  
RISK OF  
ELECTRIC  
SHOCK  
DO NOT OPEN



This symbol indicates that inside the device can lead to the danger of high voltage electric shock

#### Caution

To reduce the risk of electric shock, do not remove the cover. No user-serviceable parts inside refer servicing to qualified service personnel.



This symbol indicates important operating and maintenance instructions of the equipment.



WEEE (Waste Electrical and Electronic Equipment Directive). Please dispose of the waste properly, handling the waste in compliance with local labor laws and regulations when it reaches its lifetime.



Changes or modifications not expressly approved by the manufacturer could void the user's authority to operate the equipment.

#### Note:

1. Please avoid operating above 60 °C high temperature environment.
2. Avoid to install where more violent shaking.
3. Connect proper power supply.
4. Non-technician should not try to operate this device unless it is authorized, open or move the cover of the device may get danger, any questions please contact the professionals.

### Packing list

- PTZ camera (Include bracket)
- Rubber plugs and mounting screws
- CD
- Glove

### Installation

1. Put the full function cable through the wall mount bracket and use the rubber plugs and mounting screws to fixed it.
2. Fixed the dome camera to the bracket tightly with screws.



PTZ Camera

### Bracket

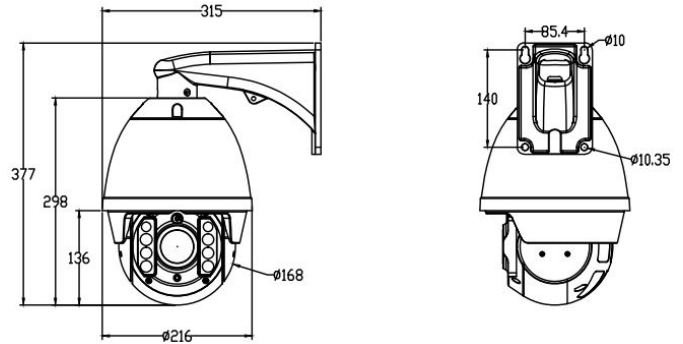

Wall mount bracket

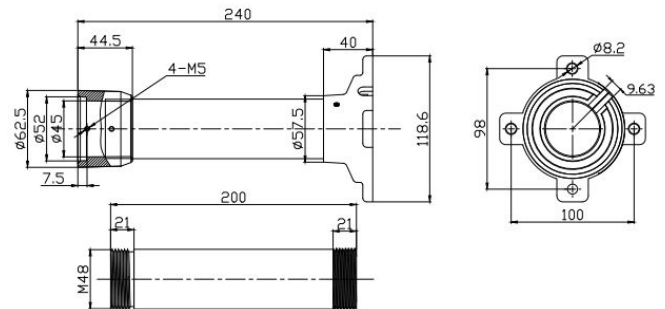

Ceiling mount (Optional)

### Interface

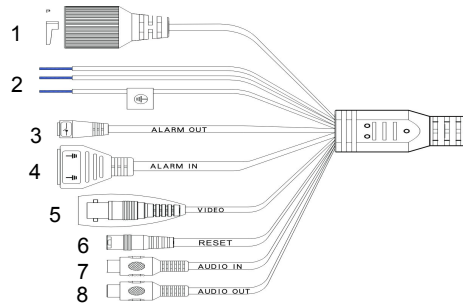

1. RJ45
2. Red 1: DC24V+ Black 1: DC24V- Yellow 1: Frame GND
3. Alarm output
4. Alarm input
5. Analog video output
6. Reset button
7. Audio input (Red)
8. Audio output (White)



- Please use the plastic or metallic sheath to protect the connection cable for safety
- DC24V power supply

### Installation environment requirements

Far away from high-temperature or humid environment, notice ventilation and avoid installing in shaky place.

### Recommend operating environment

-20°C~60°C

### Hardware installation steps

Please make sure LAN and WAN are working smoothly before the Network High Speed Dome installation. After checked all the network system in good condition, keep your hands clean and dry, following the steps below.

- Open the box to check the goods
- Take out all goods which needed for installation
- Connect the wires by your need(power supply,cable,audio,etc)
- Connect the power supply

#### Note:

- When open the box, please check all of parts carefully, confirm the parts as same as packing list.
- Please read the user manual carefully before the installation.
- Make sure to turn off all the power when install the camera
- Please confirm the power transformer, avoid the device damage with unmatched power source

#### Specification: (varies depending on the model)

Pick-up device	1/2.8" CMOS
Optical zoom	23X
Effective Pixels	2MP
S/N Ratio	≥55dB
Min. Illumination	Color: 0.1Lux@F1.6 (ACG-ON) B/W : 0.01Lux@F1.6 (ACG-ON)
Focal Length	f=4.7~108.1mm
FOV	55.8°~3.2° (Near-Far)
Zoom speed	About 3s
AF Control Mode	Auto/ Semi-Auto/ Manual
WB Mode	Auto/Auto Low Color Temperature/ White low lamp/ 4000K/ 5000K/ Sunshine/ Dark clouds/ Flash light/ Fluorescent lamp/ High fluorescent lamp/ Water bottom/ Customized
Iris control	Auto/ Manual
Shutter	1/5~1/5000
Gain	100、150、200、300、400、600、800、1600、 3200、6400、12800、25600、51200、102400
BLC	Close/ Open
WDR	Close/1~5
Day&Night	Color/ B/W /Auto
Image Flip	Vertical /Horizontal
3DNR	Close/1~5
IR Beam Distance	150m IR distance
Angle Field of IR	Change with focus
IR Control	Brightness and angle changed with scene
<b>Operation</b>	
Horizontal rotate	360 ° continuous rotation
Vertically rotation	0-90°
Manual control speed	0.1°-180°/s
Preset	255
Preset Accuracy	0.1°
Preset speed	200°/s
Area Scan	1
Pattern	4
Cruise	4
Proportion zoom	Auto
PTZ Watch	Close/preset/Cruise/Pattern /Area scan
Auto reverse	Machinery reverse
Power Memory	Support
PTZ 3D	Support

Speed Dome Cameras upgrade	Support online remote upgrade		
Network			
Video encoding	video compression		H.264/ MJPEG
	Main-stream	resolution	1920×1080(1080p) , 1280×960(960p) ,1280x720(720p)
		frame rate	1~50(60)/fps
		Bit rate	800Kbps~10000Kbps
	Sub-stream	resolution	720×480(D2), 640×480(VGA), 352×240, 352×288(CIF), 320×240(QVGA)
		frame rate	1~50(60)/fps
		Bit rate	100Kbps~1000Kbps
Audio encoding	AAC		
Privacy Mask	8 zones		
OSD	support date time、bit stream information overlay, camera title overlay, font size and color、 overlay location adjustable		
Image	Brightness, Contrast, Saturability, Sharpness, Hue adjustable through explorer		
Port protocol	Onvif,GB/T28181		
Network protocol	IPv4, TCP, UDP, HTTP, SMTP, FTP, NTP, DNS, DDNS, DHCP, RTSP, RTP, RTCP		
TF card	Max 64G		
Poe	Support		
Alarm input	2ch input		
Alarm output	1ch output, support alarm linkage		
Alarm action	TF card video recording/ FTP transmission/ Email inform/ snapshot / Preset / alarm output		
Audio	1ch input 1 output, listening and bi-directional talk		
General			
IP Grade	IP66		
Operating temperature	-20℃~60℃		
Humidity	10%~90% comparatively Humidity(Non-condensation)		
Size	377 (H) x 216 (D) mm		
Weight	About 8.5Kg		
Power supply	DC24V/1.5A (±10%)		
Power Consumption	30W MAX		